

XCS6533A12B

(Old# LCS-6533ADA1.25B)

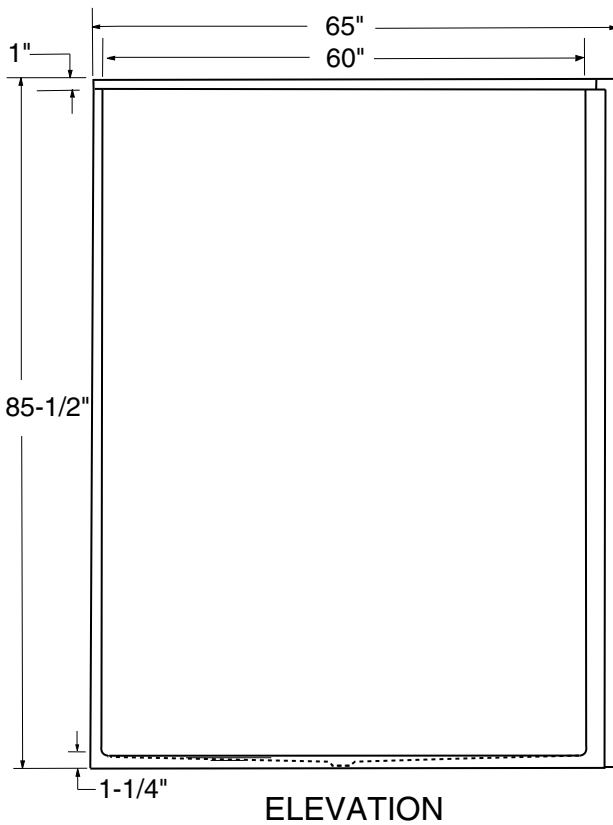

ADA COMPLIANT

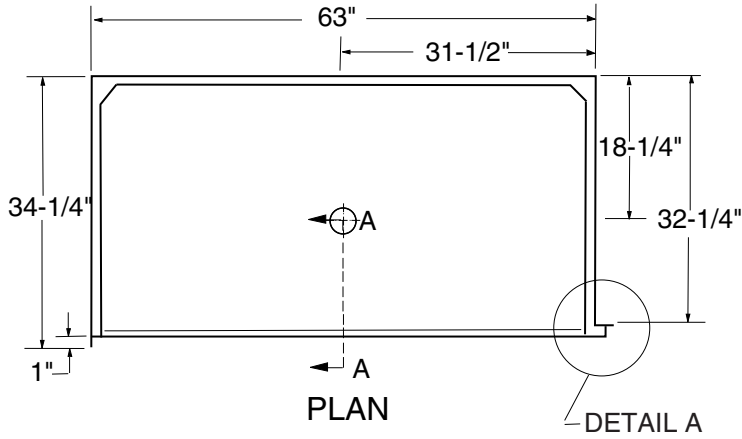

DESCRIPTION

- One piece fiberglass showerstall.
- Complies with ADA minimum inside dimensions of 60"x30" for roll-in showers.
- "Reveal 90" self-trimming flange allows for clean drywall installation and keeps moisture away from it.
- 1/2" Tri-cell laminate core for wall stiffness.
- Plywood backing for seat and grab bars.
- "Classic Tile" look finish.
- Luxurious polyester Gelcoat finish in solid colors and available Sprayable Solid Surface.
- Accessories available:
shower valve, matching soap dish,
glide bar/hand shower, curtain and rod

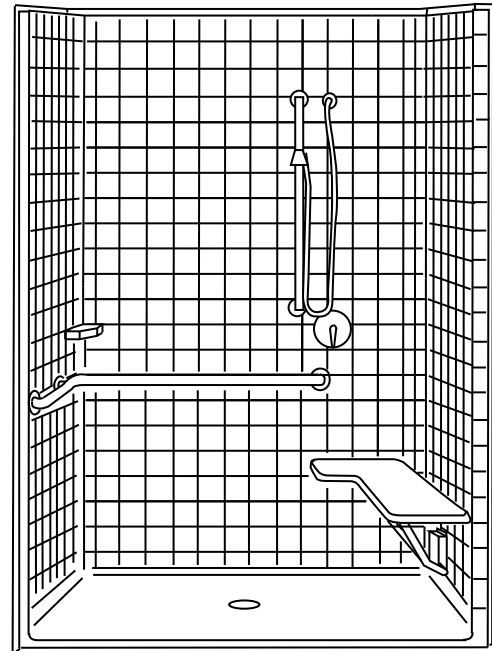

Shown here as Right hand seat/Right hand plumbing model with optional fold-down seat, corner grab bar, soap dish, glide bar kit and valve.

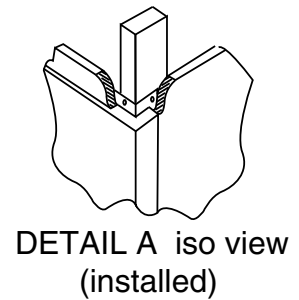
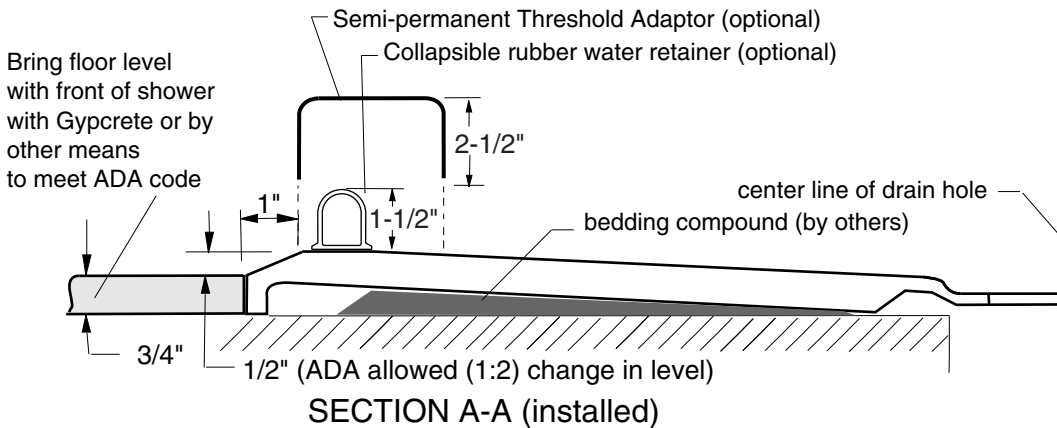

DETAIL A iso view (installed)

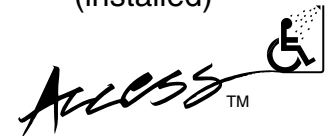

BARRIER FREE ARCHITECTURALS INC. 1-877-717-7027 www.barrierfree.org	TITLE : Roll-in Shower, classic tile, A.D.A. compliant MODEL : XCS6533A12B	SCALE : 1/2"=1'0" SHT. 1 of 4
--	---	----------------------------------